

11/23/2010

Row Length 74.5

KBS LTER Cellulosic Biofuels Experiment

C1	C2	C3	C4	C5	C6	C7	C8	C9	C10	C11	C12
401	402	403	404	405	406	407	408	409	410	411	412
			94 1/2	93	93	93 1/2	93	93	93	93	93 1/2

Block 4

C3	C4	C5	C1	C12	C10	C8	C9	C7	C6	C11	C2
301	302	303	304	305	306	307	308	309	310	311	312
	93	92		91	91	92	93	93	93	93	

Block 3

C9	C1	C4	C6	C5	C10	C3	C7	C11	C2	C8	C12
201	202	203	204	205	206	207	208	209	210	211	212
92		92 1/2	92	92	92		92	92		91	90 1/2

Block 2

C11	C9	C8	C10	C3	C5	C7	C1	C12	C4	C6	C2
101	102	103	104	105	106	107	108	109	110	111	112
96	96	95	94		95	95		95	94 1/2	95	

Block 1

40' (12.2 m)
90' (27.4 m)
30' (9.1 m)

Treatment	Description
C1	Continuous corn
C2	Corn-soybean
C3	Soybean-corn
C4	Switchgrass (Cave-in-rock) + N
C5	Switchgrass (Cave-in-rock) no N
C6	Switchgrass (Southlow) + N
C7	Switchgrass (Southlow) no N
C8	C3 - C4 - legume mix
C9	MI native prairie grasses (6 spp.)
C10	MI native prairie grasses (10 spp.)
C11	MI native prairie grasses (18 spp.)
C12	MI native prairie grasses (30 spp.)

All treatments established June 2008
Each plot is 30' x 90' (9.1 m x 27.4 m)

Location within main LTER site

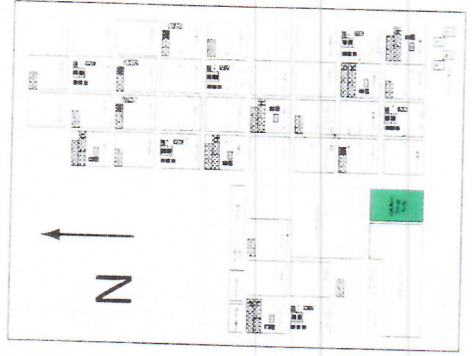

DRY WTS.

tare x2 = ~~89.98g~~ 90.20g

C 12-305	696.55	6	##
C6-204	785.19	7	##
12-212	1013.0	12	III
12-109	727.59	8	
7-309	555.77	11	'
7-407	595.12		
6-310	683.72		
7-107	577.43	12-412	806.76
7-208	751.08		
6-406	625.06		
6-111	606.39		
11-101	534.16		
8-211	695.83		
8-103	701.83		
8-307	650.25		
8-404	709.36		
11-209	755.84		
11-311	869.3-		
11-411	774.57		
10-104	639.13		
10-206	475.71		
10-306	667.67	9-409	787.98
10-410	636.15		
9-102	573.84		
9-201	724.59		
9-308	627.87		

12/6/2010
 weighed
 CE & SWF
 data #
 from gas

Samples received
 @ field 60 &
 grease