

2010 wheat harvest plots

KBS LTER Biodiversity Study

Each plot 30' X 90' (9.1m x 27.4m)

4 Ranges 6 plots wide

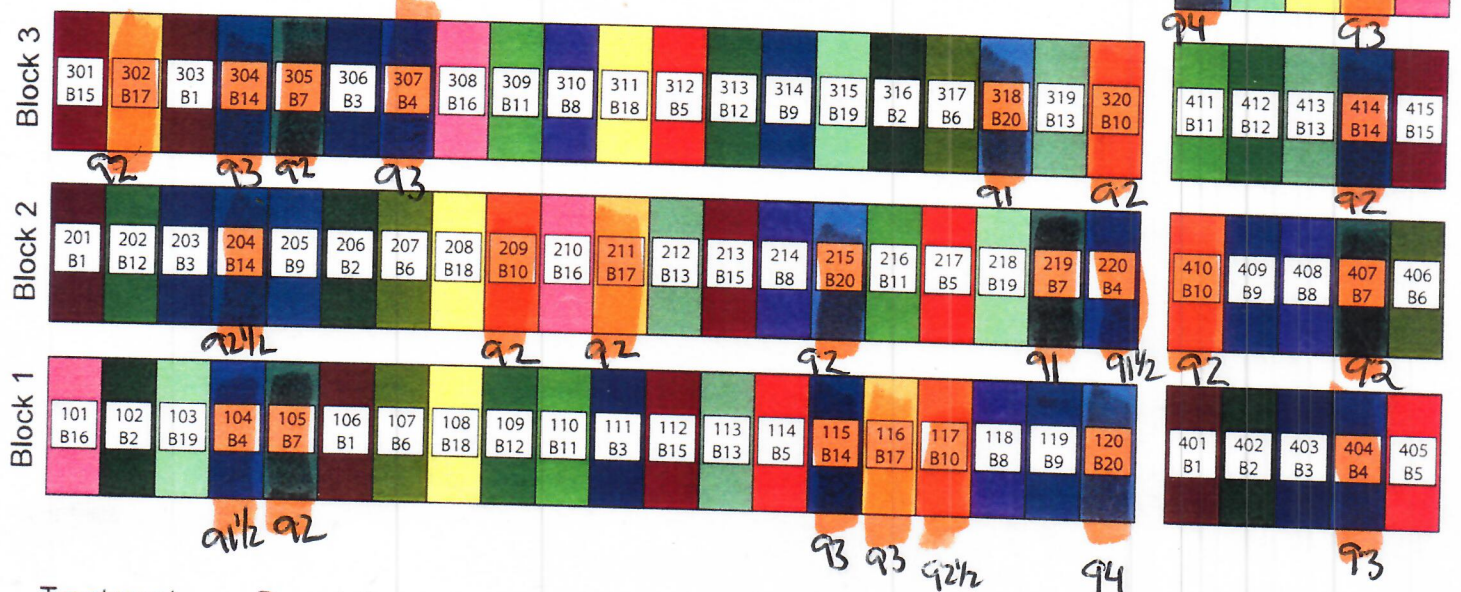

Treatment	Description	System
B1	F _{fall}	A
B2	F _{spring}	A
B3	C _{cov2} -- S -- W _{cov2}	B
B4	S -- W _{cov2} -- C _{cov2}	B
B5	W _{cov2} -- C _{cov2} -- S	B
B6	C _{cov1} -- S -- W _{cov1}	C
B7	S -- W _{cov1} -- C _{cov1}	C
B8	W _{cov1} -- C _{cov1} -- S	C
B9	C -- S -- W	D
B10	S -- W -- C	D
B11	W -- C -- S	D
B12	C -- S	E
B13	S -- C	E
B14	W -- S	E
B15	C _{cov1}	F
B16	S _{cov1}	F
B17	W _{cov1}	F
B18	C	G
B19	S	G
B20	W	G

Location within main LTER site

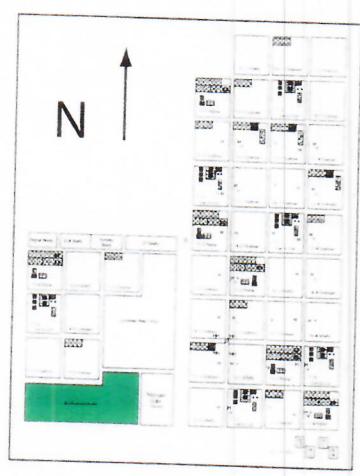

System (Trt)	Total Species	Species/year
A (B1-2)	10	5-7
B (B3-5)	5	1-3
C (B6-8)	4	1-2
D (B9-11)	3	1
E (B12-14)	2	1
F (B15-17)	2	2
G (B18-20)	1	1

Management Key

- F = Fallow
- S = Soybean
- C = Corn
- W = Wheat (red)
- cov1 = 1-species cover (legume)
- cov2 = 2-species cover (legume + small grain)